

VERNON



COMPOSITION BOOK • 9½ IN. x 7½ IN.

AVAILABLE AS:

No. 1130 (09-9130)	60 SHEETS	COLLEGE RULED & MARGIN
No. 1130-P (09-9132)	60 SHEETS	COLLEGE RULED & MARGIN
No. 1143-X (09-9134)	100 SHEETS	COLLEGE RULED & MARGIN

No. 1130-P (09-9132) NUMBERED PAGES, No. 1143-X (09-9134) SECTION SEWED

Made in U. S. A.

VERNON ROYAL, INC., Elizabeth, N. J. 07208

Chie Ishizaki

Dear Sir

The North Carolina State University Society of Women Engineers is pleased to announce their ~~first~~ second Annual Spring Symposium in March 24, 1978.

This Symposium is to promote and encourage women who are interested in engineering and scientific careers and to ~~perform~~ ^{inform} them of ~~some~~ ^{some} aspects where entering into and being successful in professional careers. It ~~is~~ ^{also} to provide an opportunity for students to meet with other women engineers and science students as well as women working in the industry.

In order to make this Symposium a success for everyone, we would like to ask some donation. If you are interested in supporting us, please contact _____

Again ~~thank~~ your ~~help~~ ^{consideration} is appreciated very much.

Sincerely

ロウラ ホルス

ロ
ウ
ラ
ホ
ル
ス
ワ
イ
ラ
ー

ロ
ウ
ラ
ホ
ル
ス
ワ
イ
ラ
ー



March 24th

National Student Exchange

Sunday 2:00 p.m.

- 1. [Faint text]
- 2. [Faint text]
- 3. [Faint text]
- 4. [Faint text]
- 5. [Faint text]
- 6. [Faint text]
- 7. [Faint text]
- 8. [Faint text]
- 9. [Faint text]
- 10. [Faint text]
- 11. [Faint text]
- 12. [Faint text]
- 13. [Faint text]
- 14. [Faint text]
- 15. [Faint text]
- 16. [Faint text]
- 17. [Faint text]
- 18. [Faint text]
- 19. [Faint text]
- 20. [Faint text]
- 21. [Faint text]
- 22. [Faint text]
- 23. [Faint text]
- 24. [Faint text]
- 25. [Faint text]
- 26. [Faint text]
- 27. [Faint text]
- 28. [Faint text]
- 29. [Faint text]
- 30. [Faint text]

and [faint text] [faint text]

Lids Sandu

215-339-6599

march 24th

Work shop

1. Financial Planning - Wachovia
2. Interviewing Techniques - Linda Sanders ✓
3. Dress For Success -
4. Technical Writing - Dr Seidel ✓
5. Careers in Management - Carol Drigger ✓
6. Professional Licensing
7. Career Planning - Sue Spenger
8. Careers + children

20 Companies

- Mr. W.S. WARD
- ① Monsanto
 - ② Dupont
 - ③ Union Carbide
 - ④ CP & L
 - ⑤ Burnoughs - Wellcome
 - ⑥ Proctor & Gamble
 - ⑦ GE
 - ⑧ IBM
 - ⑨ Owens
 - ⑩ Southern Bell
 - ⑪ Westinghouse
 - ⑫ Texer Lab
 - ⑬ Rockwell International

industries human service
and education systems.

John Robert Powers
School of Fashion Consultant
Consultant

Mary O'Brian
Retired faculty member
for Gillbr Tech

137-2464
851-7254

en Sperger
im Department Manager
2-1100

~~ager~~
853-2143
3 2000
- 545-4674
HST

Friday 2612 Whispering
Albany GA Rd.
Tancey Model 31707
Charlotte

H. Lee Swanson Sr. U.P.

(Betsy Myrick U.P.)

PO Box 27886

Raleigh NC

27611

Dwan 737-5439

Plant no

① Patricia Hartzell 755-7711
Wachovia Personal banker

② Despina Boindiris 781 - 4341
543-5881
IBM Design Engineer

③ Susan Morgan ^{→ velvet close}
~~Saunders~~ _{Int'l}
Linda ~~Sander~~ ← Susan Morgan
Development Supervisor
TEFLON PRODUCT Development
Marshall Lab, Philadelphia
215-339-6599
Tommy Friday night

④ Dr. Kathryn L. Seidel
Associate Professor at WCSU
Department of English
Teach Technical & Business writing
207A 737-2464
851-7254

⑤ Sue Ellen Sperger
Production Department Manager
752-1100

⑥ ~~Carol Drigger~~
more 912-883-2143
912 883 2000
704-545-4674
M-F

Friday 2612 Whispering
Albany GA Pt.
Tancey Motel
31707
Charlotte

(7) Janet O'Brien
en

1937 - 77-77

(8) Fashion

LABELS PRINTED = 407

McKinnon Centre 737-2277

3 overhead projector
1 slide projector

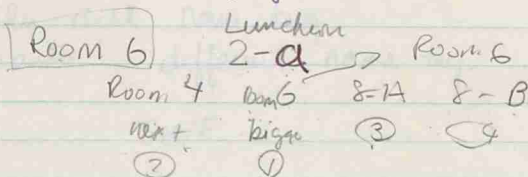

39 registration

27

Room 6 → coffee donuts

I would introduce Carol Pierce
Welcome

Luncheon head.

Prof Richard Dwan Chi

Carol Pierce Isabelle Cannon

Dwan introduce Prof. Richardson

Prof Richardson introduce Marge Cannon

Dwan introduce company representatives
and guest.

I introduce workshop leader

Foldu - Program
workshop material
lencal

Pacl - Continue education

Favor - Pen

Jonathan Bell Name tag

Monsanto different name tag.

SWE

Expense

Telephone \$15.90 + ^{2.53} ~~\$3.00~~

Mail \$30.00

letter \$10.00

Printing Registration \Rightarrow 11.90

Carol Pearce \$250.00 + Expense

Fashion \$75.00

McKinnon Centre \$1.00 per person.

Print Poster \$31.72

News paper add \$55.00

Monsanto \$50.00

Southern Bell \$100.00 \$550

Dupont \$100.00

CD & L \$100.00

IBM \$100.00

P&G \$100.00

* Isabella canon

Expenditure

Telephone = \$5.70 + \$2.53

Mail (stamp) = \$30.00

Typing letter = \$10.00

Printing Registration form = \$11.90

Speaker (Carol Pearce) = \$250 + Expenditure

Fashion = \$75.00

McKimmon Center = \$1.00 per person

Printing Poster = \$31.72

News paper ad =

Printing material = \$27.65

Income

C P & L \$100.00

Procter & Gamble \$100.00

GENERAL ELECTRIC \$100.00

Olins \$100.00

IBM \$100.00

Southern Bell \$100.00

Monsanto \$50.00

Du Pont \$100.00

Guest for luncheon

- Dean ~~Monteith~~ t. Mayor 328 Eddick
✓ Dean G. F. Ely }
✓ Prof. Eileen Phelan } operations Research
✓ Prof. Chris Weisbrook } mechanical Engr.
Prof. Frances Richardson → 3175 Broughton Hall
✓ Mary Yionoulis 787 - 1584
Terry

Companies Representative

CP&L ⇒ Mr.

Proctor & Gamble ?

GENERAL ELECTRIC No

OlinS ?

IBM Despina

Southern Bell ⇒ Ms. Susan Leonard.

Monsanto ?

Du Pont ⇒ not coming

Carol Price

As the past chair of New Hampshire
Commission on Status of Women, she
is well acquainted on concern of women.

She specialize in consulting and
training program in business and industries.

Partner of New dynamic's Associate

She is experienced group training for
both men + women groups.

Well known author and speaker on these issues.

Make women aware of technical field +
professional personal development.

PROGRAM Rhonda Walker 851-5224

737-6796

Arrangement Nancy Walker

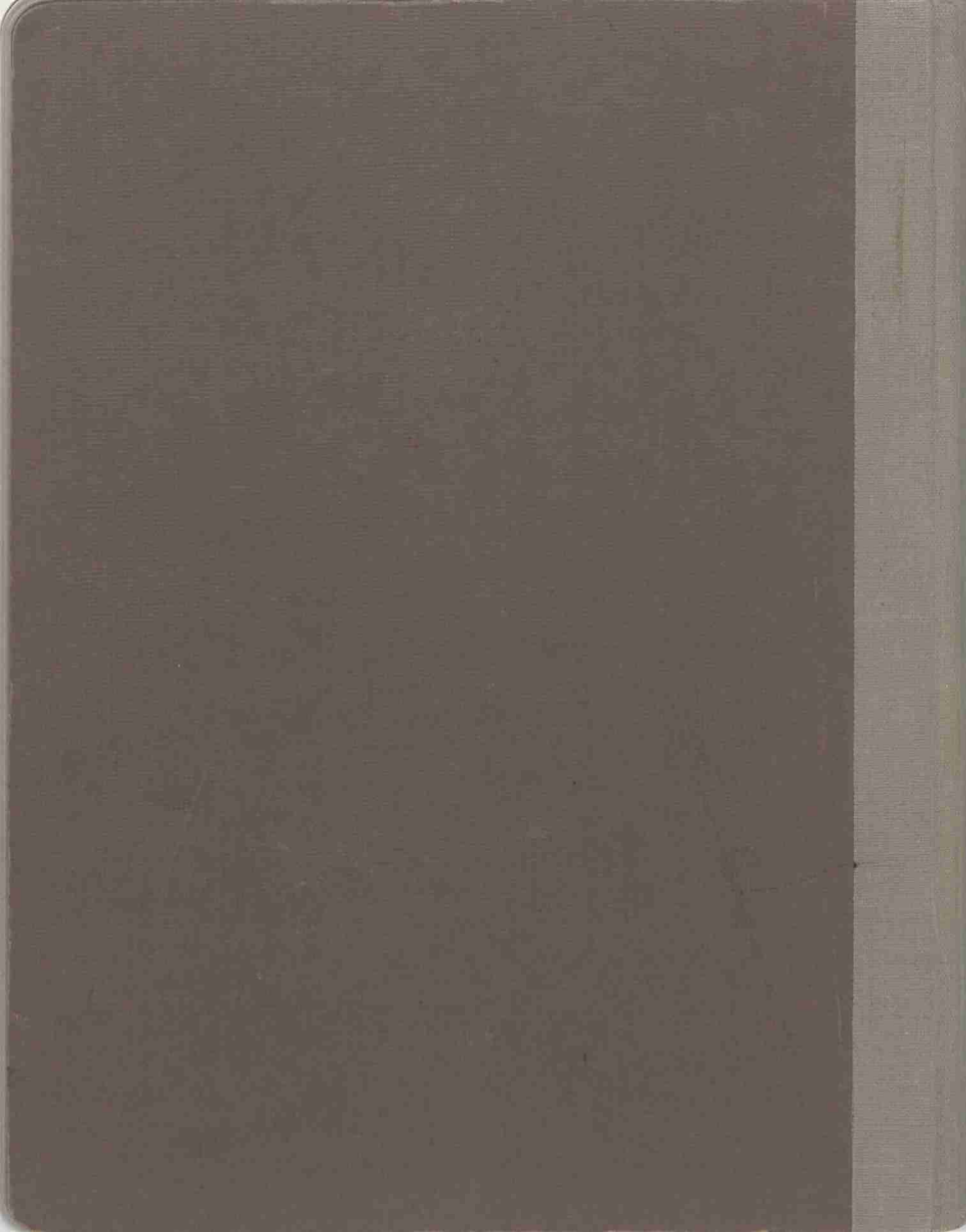

Copy of
Correspondance
Symposium
1976-1977

January 28, 1977

Mr. Calvin L. Moyer
College Relations Coordinator
E. I. DuPont de Nemours and Company
Wilmington, Delaware 19898

Dear Mr. Moyer:

On behalf of the NCSU Student Section of the Society of Women Engineers,
I want to thank DuPont for its contribution to our Symposium Fund.
Your donation, along with others, enables us to finalize our plans
knowing we can meet expenses.

We will mail final information about the symposium to you in early March.
We hope that a representative from DuPont will be able to join us at the
luncheon.

Sincerely,

Mary C. Whitton
Symposium Coordinator
NCSU Section - S.W.E.

MCW:tv

copy
3917-D Marcom Street
Raleigh, N. C. 27606
February 3, 1977

Mr. Mac Gowin
Proctor and Gamble Paper Products Co.
Box 1747
Albany, Georgia 31702

Dear Mr. Gowin:

On behalf of the NCSU Student Chapter of the Society of Women Engineers, I would like to thank you for the conference funds and for the lovely luncheon. It is very important for our organization to send a representative to the National Student Conference of SWE. At the conference, we have an excellent opportunity to learn more about the National Organization and meet other engineering students from all over the country. This exposure greatly aids our strengthening efforts within our student chapter.

All of our members enjoyed the slide presentation about Proctor and Gamble Paper Products Division, but most of all enjoyed meeting and talking with Debbie and Patrice about their background and career plans. We are always eager to talk with engineers in industry, and we all benefited from their candid views on the subject. Industrial management is a career few engineering students hear about in their classes, and your visit and presentation was certainly a learning experience for our members.

Again, thank you for your visit, the luncheon, and the conference funds.

Sincerely,

Carol Driggers, EE '77
President NCSU
Chapter of SWE

copy

3917-D Marcom Street
Raleigh, N. C. 27606
February 3, 1977

Ms. Debbie Dukes
Ms. Patrice
Proctor and Gamble Paper Products Co.
Box 1747
Albany, Georgia 31702

Dear Debbie and Patrice:

On behalf of the NCSU Chapter of SWE and myself, I want to thank you for your visit, the luncheon and the slide presentation. We are very apprehensive about industry and your candid views and experiences put alot of our fears to rest. As I told the other members, your presentation was representative of my trip to Albany Paper Products plant. I'm sure they feel better prepared to take such a trip.

After being entertained so well while in Albany, it was a pleasure to get to show you around our campus. If either of you are ever back in the Raleigh area again, we would like very much to have you as our guest at a SWE dinner meeting. I hope to be back in touch with you again soon.

Sincerely,

Carol Driggers, EE '77
President NCSU
Chapter of SWE

8 February 1977

Ms. Judie Maddox
P.O. Box 124
Aiken, SC 29801

Dear Ms. Maddox:

The NC State University student section of the Society of Women Engineers is planning a Spring Symposium entitled "Assertiveness, Life-planning, and Decision Making". We would like very much for you to speak at the Symposium in your capacity as National Vice President of SWE. Because our section is newly chartered and the Symposium is one of our first major undertakings, we are especially excited about your coming. I understand that Despina Boindiris of IBM has been in contact with you about our plans.

The Symposium is planned for Saturday, April 2, 1977. We would like for you to be our speaker at the luncheon addressing yourself to a topic such as Women as Engineers and Scientists and the current purpose of SWE. The morning session will be a presentation on Assertiveness. The afternoon will be a series of shorter workshops on topics of interest including: Getting a Job, Careers & Children, Financial Planning, Problems in the School Setting, and Problems in the Job Setting. We are aiming our symposium at the women Engineering and Sciences students from NC State, Duke and N.C.A.&T. Universities and we expect somewhere between 30 and 50 participants.

The section is excited about the possibility of your being with us for the Symposium. We will send you complete information after we have heard from you.

Sincerely,

Mary C. Whitton, EE '78
Symposium Coordinator

MCW:sm

February 8, 1972

Ms. Judie Maddox
P.O. Box 124
Aiken, SC 29801

Dear Ms. Maddox,

The N.C. State University student section of the Society of Women Engineers is planning a Spring Symposium entitled "Assertiveness, Life-Planning, and Decision Making." We would like very much for you to speak at the Symposium in your capacity as National Vice President of SWE. Because our section is newly chartered and the Symposium is one of our first major undertakings, we are especially excited about your coming. I understand that ~~Respira~~ Boinodiris of IBM has been in contact with you about our plans.

The Symposium is planned for Saturday, April 2, 1977. We would like for you to be our speaker at the luncheon addressing yourself to a topic such as Women as Engineers and Scientists and the current purpose of SWE. The morning session will be a presentation on Assertiveness. The afternoon will be a series of shorter workshops on topics of interest including: Getting A Job, Careers & Children,

Financial Planning, Problems in the School setting,
and Problems in the Job setting. We are
aiming our symposium at the women
Engineering and Sciences students from
N.C. State, Duke, and N.C. A&T. Universities
and we expect somewhere between 30 and 50
participants.

The section is excited about the possibility
of your being with us for the Symposium. We
will send you complete information after
we have heard from you.

Sincerely,

Mary C. Whitten EE '78
Symposium Co-ordinator

NCSU STUDENT SECTION SOCIETY OF WOMEN ENGINEERS

February 10, 1977

Mr. Girard Davidson
Personnel Department
Duke Power Company
430 S. Church Street
Charlotte, North Carolina 28202

Dear Mr. Davidson:

The North Carolina State University Student Section of the Society of Women Engineers is planning a Spring Symposium for women in engineering and related fields. Our theme is "Assertiveness, Life Planning and Decision Making." We have enclosed a preliminary outline of our program and information about the Society of Women Engineers.

Our projected budget for this symposium is \$700. The section is contributing the time of its 25 members for organization and arrangements, and is conducting fund-raising projects to cover the direct expenses of the symposium. In order to invite dynamic leaders to the symposium, we need financial support from outside sources. Because of our common concerns, we are seeking support from companies who have demonstrated active interest in equal opportunity for women in engineering. A contribution of \$100 from Duke Power Company will help assure that we offer the symposium participants a valuable experience in personal and professional development. Contributing companies will be invited to send a representative to the symposium luncheon at which time they will be recognized. We will also send your company a complimentary copy of a booklet containing resumes of many NCSU women engineering and science students which will be distributed in early spring 1977. Your contribution will give continued support to affirmative action programs for women in engineering and encourage our section members in their professional development.

If you want further information, please contact:

Chie Ishizaki Dawn Upchurch
-Mary Whitton, Symposium Coordinator
c/o NCSU Student Section
Society of Women Engineers
2158 Burlington Engineering Laboratories
North Carolina State University
Raleigh, North Carolina ~~27607~~ *27650*

Phone: Evenings - 919/833-5401 *851-8173 (Chie Ishizaki)*
Days - 919/737-3272 (Prof. F. M. Richardson)

In order that we can complete our conference plans on time, we would very much appreciate having your response as early as feasible. We look forward to hearing from you, *and thank you for yours*

Sincerely,

Mary C. Whitton, EE'78



SOCIETY OF WOMEN ENGINEERS

February 14, 1977

Ms. Mary C. Whitton
600 Devereux Street
Raleigh, NC 27605

Dear Ms. Whitton:

I will be glad to be the luncheon speaker at the Spring Symposium. DESPINA did discuss the symposium with me briefly. It sounds very interesting to me.

Sincerely,

Judith H. Maddox
National Vice President

JHM:pab



E. I. DU PONT DE NEMOURS & COMPANY
INCORPORATED
WILMINGTON, DELAWARE 19898

EMPLOYEE RELATIONS DEPARTMENT

*Mary,
I think this was
intended for you,
Tricia*

March 7, 1977

Dr. F. M. Richardson, Assoc. Professor
Engineering Research Services Division
P.O. Box 5995
2158 Burlington Engineering Laboratories
Raleigh, NC 27607

Dear Fran:

I certainly was pleased to get your phone call awhile back and wish to apologize for not writing sooner. I hope you got my message saying I would be able to attend your Career Day on Saturday, April 2. What I plan to do is leave Rapid City, South Dakota, (I'm attending the Northern Great Plains Regional AIChE Conference there) on the afternoon of Friday, April 1, and fly to Atlanta. I can catch a flight to Raleigh Saturday morning and be at NC State before noon. Just to cover things, however, I'd like to invite another Du Pont engineer to the Career Day, if it's okay with you. I'll tentatively plan to invite Caeli Collins. She can be there all day and has said she would be most pleased to help out in any way.

I enjoyed talking to Mary Whitton and look forward to meeting her. In fact, I am very much looking forward to participating in your program and to visiting with you again.

Sincerely,

PERSONNEL DIVISION

Linda A. Saunders
Linda A. Saunders
College Relations Representative

LAS:bap

NCSU Student Section
Society of Women Engineers
2158 Burlington Engineering La
N. C. State University
Raleigh, N. C. 27607
March 15, 1977

Mr. William F. Troxler, President
Troxler Electronic Laboratories, Inc.
P. O. Box 12057
Cornwallis Road
Research Triangle Park, N. C. 27709

Dear Mr. Troxler:

Thank you once again for your company's generous contribution in support of our symposium, "Assertiveness, Life Planning, and Decision Making", to be held on April 2. We would like to recognize a representative from your company at the luncheon to be held at 12 noon. We would appreciate it if you let us know if your representative will be attending by March 24 so that a space can be reserved.

We are looking forward to an especially meaningful symposium.

Sincerely,

Claire Cowart, CHE '79
Publicity Chairman

NCSU Student Section
Society of Women Engineers
2158 Burlington Engineering Laboratories
North Carolina State University
Raleigh, North Carolina 27607
March 15, 1977

Mr. Gerard H. Davidson
Manager, Employee Relations
Duke Power Company
422 South Church Street
Charlotte, North Carolina 28242

Dear Mr. Davidson:

Thank you once again for your company's generous contribution in support of our symposium, "Assertiveness, Life Planning, and Decision Making," to be held on April 2. We would like to recognize a representative from your company at the luncheon to be held at 12 noon. We would appreciate it if you let us know if your representative will be attending by March 24 so that a space can be reserved.

We are looking forward to an especially meaningful symposium.

Sincerely,

Claire Cowart, CHE '79
Publicity Chairman

NCSU Student Section
Society of Women Engineers
2158 Burlington Engineering Laboratories
N. C. State University
Raleigh, North Carolina 27607
March 15, 1977

Mr. C. L. Moyer
College Relations Coordinator
Du Pont de Nemours and Company, Inc.
Wilmington, Delaware 19898

Dear Mr. Moyer:

Thank you once again for your company's generous contribution in support of our symposium, "Assertiveness, Life Planning, and Decision Making", to be held on April 2. We would like to recognize a representative from your company at the luncheon to be held at 12 noon. We would appreciate it if you let us know if your representative will be attending by March 24 so that a space can be reserved.

We are looking forward to an especially meaningful symposium.

Sincerely,

Claire Cowart, CHE '79
Publicity Chairman

P. O. BOX 2178

DUKE POWER COMPANY
GENERAL OFFICES
422 SOUTH CHURCH STREET
CHARLOTTE, N. C. 28242

TELEPHONE: AREA 704
373-4011

March 22, 1977

Ms. Claire Cowart
Publicity Chairman
NCSU Student Section
Society of Women Engineers
2158 Burlington Engineering Laboratories
North Carolina State University
Raleigh, North Carolina 27607

Dear Ms. Cowart:

Thank you for your kind invitation to attend the luncheon at your symposium in Raleigh at 12:00 noon on April 2. I will be happy to represent Duke Power Company at this luncheon.

Please advise the building in which this luncheon will occur.

I am looking forward to this event.

Sincerely yours,



Gerard H. Davidson
Manager
Employee Relations

GHD/mh

TROXLER ELECTRONIC LABORATORIES, INC.

P. O. Box 12057, Cornwallis Road, Research Triangle Park, North Carolina 27709, U. S. A.

March 22, 1977

Ms. Claire Cowart, Publicity Chairman
Society of Women Engineers
2158 Burlington Engineering Labs
N.C. State University
Raleigh, NC 27607

Dear Ms. Cowart:

Thank you for your letter of March 15 inviting someone from here to attend a luncheon on April 2.

Sorry, but that is the day of our Annual Stockholder's Meeting which begins at 10:00 a.m. and obviously eliminates our participation.

We wish you a successful meeting.

Sincerely,



William F. Troxler
President

WFT/jc



E. I. DU PONT DE NEMOURS & COMPANY
INCORPORATED
WILMINGTON, DELAWARE 19898

EMPLOYEE RELATIONS DEPARTMENT

April 6, 1977

Ms. Mary C. Whitton
Symposium Coordinator
North Carolina State Student Section
Society of Women Engineers
2158 Burlington Engineering Laboratories
NCSU
Raleigh, North Carolina 27607

Dear Ms. Whitton:

Just a brief note to say that your Symposium for Women in Engineering and Sciences last Saturday was excellent. You certainly did a tremendous job of putting together an enjoyable and educational program. By the end of the day, Caeli even forgave me for giving her the wrong directions.

Please pass on my compliments to Claire Cowart, Carol Driggers and the others on your committee.

I hope to see you again sometime when I am back visiting NC State. Please give my regards to Professor Richardson.

Sincerely,

PERSONNEL DIVISION

Linda A. Saunders
College Relations Representative

LAS:bap

P.S. Would it be possible for you to send me a list of the students participating in the Symposium?

April 15, 1977

Ms. Linda Grimsley
3119 Birnamwood Road
Raleigh, North Carolina 27607

Dear Ms. Grimsley,

I want to thank you so much for your contribution to the SWE symposium April 2. Ever since people have been talking about how much they learned from your presentation and from practising assertive behaviors. Many of the participants have said that your presentation was the best part of the program. I hope you will let us know when you will be teaching the longer course as some of our members might want to enroll.

Again, thank you on behalf of the entire society.

Sincerely,

Mary C. Whitton
Symposium Co-ordinator

April 15, 1977

Ms. Judy Maddox
E. I. Du Pont
P. O. Box 124
Aiken, South Carolina 29801

Dear Ms. Maddox:

I want to thank you for your contribution to our Symposium April 2. I have a much better feel for the history of women in engineering and SWE now than I did before hearing you speak. Also, thanks for at the last minute filling in on the management workshop. Flexibility in resource people is terrific -- and as coordinator I particularly appreciated your stepping in where needed.

I was glad to get to talk with you at Despina's Friday night. As someone just getting into engineering, it is an inspiration to see folks who have withstood much greater odds than I will ever face and who have made it through. I am very grateful that you felt you could be with us in light of your recent problems at work. I hope that things continue to improve rapidly.

Again thanks from the whole society and from me personally.

Sincerely,

Mary C. Whitton
Symposium Coordinator

April 18, 1977

Ms. Deborah Dudek
First-Citizens Bank and Trust Company
20 E. Martin Street
Raleigh, N. C. 27601

Dear Deborah:

Thank you so much for being with us and doing such a great job talking about Money Matters. I have heard good comments about your sessions all week. I believe that we all have many questions answered and also have been thinking of many more. Maybe we will call you again next year to do a regular evening program for the society. Money is something that frightens most undergraduates and hearing a little about how to handle it is reassuring.

Again thanks for an outstanding job well done.

Sincerely,

Mary C. Whitton
Symposium Coordinator

April 15, 1977

Dr. George Bland
4505 Wilkes Street
Raleigh, North Carolina 27609

Dear Dr. Bland:

On behalf of the Society of Women Engineers I want to thank you for participating in our symposium April 2. We were pleased that you had agreed to do on e set of seminars - and were grateful that you were willing to fill in for Elyse Phillips in the Management Workshop.

Women I have talked to have said that they found your sessions very helpful and informative and I personally enjoyed talking almost one to one with you about your career. The longer I am in engineering the more I realize the importance of learning from those who have trod the path before me.

Again, my thanks and those of the society.

Sincerely,

Mary C. Whitton
Symposium Coordinator

April 15, 1977

Ms. Laura Foxx
Student Affairs
200 Harris Hall
NCSU
Campus

Dear Ms. Foxx:

Many, many thanks for your contribution to the SWE Symposium April 2. Although I was not in on either of your workshops, I have heard from others that they were good learning and sharing times. It certainly appeared from the other side of the room that you had lively sessions.

I hope that being with us has given you some new information about the self image of women in technical areas - you certainly had that type of audience Saturday - and I believe we are different from women in liberal arts.

If you have any criticism or comments of the program or the management of the symposium, we would appreciate hearing them from you.

Again our thanks.

Sincerely,

Mary C. Whitton
Symposium Coordinator

**NCSU STUDENT SECTION
SOCIETY OF WOMEN ENGINEERS**

April 18, 1977

Ms. Linda Saunders
Employee Relations Department
E. I. Du Pont
Wilmington, Delaware 19898

Dear Linda:

Many, many thanks for being with us for the SWE Symposium last week. You came bearing gifts - which was exactly what we needed for our folders. You came bearing wisdom - which I saw being dispensed with enthusiasm and style. I was sorry that I did not get to sit in on one of your sessions, but everyone said that they learned a lot about the interviewing process. My father said he had taken extensive notes and was going to tell me all about it. (I think he's finally beginning to like the idea his daughter is going to be an engineer!)

The section is really grateful for all that Du Pont has done to support and encourage us. Your donation toward the Symposium was one of the first - and it set us off on the right foot. Having both you and Caeli with us certainly gave us depth in our workshop resource people.

Ms. Richardson said that perhaps you will give a program for us next year. I hope that you do and that I will not be so busy then and will be able to talk with you more. Again our thanks.

Sincerely,

Mary C. Whitton
Symposium Coordinator

cc: Calvin Moyer

NCSU STUDENT SECTION
SOCIETY OF WOMEN ENGINEERS

April 18, 1977

*file
copy*

Mr. Alex G. MacFadyen, Jr.
First-Citizens Bank & Trust Company
20 E. Martin Street
Raleigh, N. C. 27601

Dear Sir:

I want to thank you on behalf of the Society of Women Engineers for providing a speaker for our Symposium, April 12. Deborah Dudek did an outstanding job as a workshop leader. She spoke to two groups, each for about 45 minutes talking about credit, savings, investments, taxes, insurance, etc. She was extremely knowledgeable in the areas and was able to give advice backed up by her knowledge of how the bank operates.

We were very pleased to have her distribute the booklet on Women and Credit that the bank is putting together.

We appreciate the fact that First-Citizens is interested in making this sort of information known and is willing to provide a speaker for our program. We were very pleased to have Ms. Dudek with us. Thank you again.

Sincerely,

Sincerely,

Mary C. Whitton
Symposium Coordinator

cc: Mr. Don Carpenter

April 18, 1977

Dr. Gene Livingston
IBM Corporation
Research Triangle Park, N. C. 27709

Dear Dr. Livingston:

I want to thank you for your contribution to the SWE Symposium April 2. Your topic was one which is of great interest to most of us. I believe every time we talk with someone who has managed career and children it encourages those of us who want both. I guess the most important thing I got from your presentation was that there will be many choices and decisions to be made and priorities to be set - and that I will have to work them out myself.

Again our thanks for being with us.

Sincerely,

Mary C. Whitton
Symposium Coordinator

April 18, 1977

Ms. Jan Talbott
%Ms. Kathleen Harer
504 Valparaiso Road
Oak Ridge, Tenn. 37830

Dear Ms. Talbott:

Many thanks for being with us for the SWE Symposium April 2. We appreciated your coming from so far away to share your experiences with us. Although I didn't get to either of your workshop sessions, I've heard nothing but good things about them. It is always good to hear from someone who is in the type of position now in which we all expect to be in a few years.

I enjoyed talking a little with you at lunchtime. I'm afraid I had the nervous hostess jitters all day and I do wish I could have heard more about your work.

Again our thanks for being with us.

Sincerely,

Mary C. Whitton
Symposium Coordinator

April 18, 1977

Ms. Caeli Collins
Engineering Department
Louviers Boulevard
Newark, Delaware 19711

Dear Caeli:

Thanks so much for being with us at the SWE Symposium April 12. We were all very sorry your day began so badly - but hope it improved as it progressed.

I've heard nothing but good reports about your workshop sessions. It means a lot to those of us still in school to hear from those of you who have just recently been where we are and are now in the positions we will be in soon.

Again our thanks for being with us.

Sincerely,

Mary C. Whitton
Symposium Coordinator

April 18, 1977

Mrs. M. K. Hunter
2414 Wycliff Road
Raleigh, N. C. 27607

Dear Mrs. Hunter:

I want to tell you how sorry we were that you were unable to be with us for the SWE Symposium April 12 and to thank you for sending such an informative letter for us to share with the participants. Hearing how other women have managed career and family lets me know it can be done and encourages one to continue looking for a personally satisfying compromise.

We hope that with the pressure of your book off you may be able to be with us for a program next year.

Sincerely,

Mary C. Whitton
Symposium Coordinator

April 18, 1977

Dr. K. O. Beatty
Department of Chemical Engineering
114 Riddick Labs
NCSU Campus

Dear Dr. Beatty:

Many thanks for being with us and contributing so well to the SWE Symposium April 12. I think that you and Mrs. O'Brien did a terrific job of presenting both the philosophical and practical views of licensing. Either alone would have been incomplete. Your reasoned, experienced approach to licensing is refreshing in an area so full of controversy and people convinced they are right.

I appreciated your being with us for most of the day. You had been in at ground zero on so much of the planning that I was glad for you to see how the whole thing came off. A special pleasure for me has been getting to know you as I fumed about the various tasks that had to be completed to make the symposium a reality. You have the patience and wisdom that I hope I will have some day.

Again our thanks for contributing so much Saturday (and lots of days before).

Sincerely,

Mary C. Whitton
Symposium Coordinator

April 18, 1977

Mrs. Janet O'Brien
Guilford Technical Institute
P. O. Box 309
Jamestown, N. C. 27282

I want to thank you for being with us and contributing so much to the SWE Symposium last Saturday. I felt that you and Dr. Beatty did a marvelous job of presenting both a philosophical and a practical view of the licensing procedure. Either would have been incomplete alone.

I must say that I admire your persistence in getting licensed in the face of such odds. It is a meaningful accomplishment.

We were delighted to have you and your students with us all day. I hope that they found the sessions informative and helpful. In an effort to improve would we undertake a similar project again, we would appreciate hearing any comments and suggested improvements that you folks could make.

Thank you again, and I hope Saturday was the beginning of a good relationship between N. C. State and Guilford Tech.

Sincerely,

Mary C. Whitton
Symposium Coordinator

April 18, 1977

Mr. Alex G. MacFadyen, Jr.
First-Citizens Bank & Trust Company
20 E. Martin Street
Raleigh, N. C. 27601

Dear Sir:

I want to thank you on behalf of the Society of Women Engineers for providing a speaker for our Symposium, April 12. Deborah Dudek did an outstanding job as a workshop leader. She spoke to two groups, each for about 45 minutes talking about credit, savings, investments, taxes, insurance, etc. She was extremely knowledgeable in the areas and was able to give advice backed up by her knowledge of how the bank operates.

We were very pleased to have her distribute the booklet on Women and Credit that the bank is putting together.

We appreciate the fact that First-Citizens is interested in making this sort of information known and is willing to provide a speaker for our program. We were very pleased to have Ms. Dudek with us. Thank you again.

Sincerely,

Sincerely,

Mary C. Whitton
Symposium Coordinator

cc: Mr. Don Carpenter

For Susan

*Copies also to
Mary W
Carol D*

April 19, 1977

Prof. F.M. Richardson
Society of Women Engineers
2153 Burlington Engineering Laboratories, NCSU
Raleigh, NC 27607

Dear Prof. Richardson:

Thank you so much for the "Assertiveness, Life-Planning, Decision Making" Seminar on April 2, 1977. Both Jean Ramsey and I thought it was an enlightening experience. NCSU Student Chapter of the Society of Women Engineers did an excellent job with this presentation.

I am presently Chairman of the Engineering Promotion Council at Duke University, (we do not have an SWE chapter) and our organization would be interested in co-sponsoring such a symposium for men and women in engineering and the sciences in the Fall of '77. Surely men's roles of today are changing as rapidly as women's roles and both sexes could benefit from such a seminar.

I have a small favor to ask. Jean and I would love to have a "Love an Engineer" T-shirt in yellow, one large and one small. I believe they were \$ 4 each, and enclosed is a check for \$ 8. Please send them to:

Loretta Williams
311 S. LaSalle St. 50-T
Durham, NC 27705

If you wish to contact me before May 2, my telephone number is 286-9596, or call our advisor, Dr. Marion Shepard at 684-2832.

Sincerely,

Loretta Williams

Loretta Williams
Chairman, Engineering Promotion Council

ASSERTIVENESS
 LIFE-PLANNING
 DECISION MAKING

A Symposium for Women in
 Engineering and Sciences

April 2, 1977
 N.C. State University

NCSU Student Section
 Society of Women Engineers

SYMPOSIUM PROGRAM

- 8:30-9:30 Registration--Coffee and Doughnuts
Lobby of McKimmon Center
- 9:30-11:45 Welcome: Mary Whitton, Symposium
Co-ordinator
Introduction to Assertiveness
Training: Linda Grimsley
- 12 Noon Luncheon
Women in Engineering and the
Purpose of SWE: Judy Maddox
- Workshop Sessions
- 1:45-2:30 Corner 1: Money Matters
Corner 2: Professional Licensing
Corner 3: Getting into Management
Corner 4: Getting the Job You Want
- 2:40-3:25 Sessions from 1:45 will be repeated
- 3:45-4:30 Corner 1: Career Planning
Corner 2: Problems in the Work
Environment
Corner 3: Problems in the School
Environment
Corner 4: Careers and Children
- 4:40-5:25 Sessions from 3:45 will be repeated
- 5:30 Adjournment

SYMPOSIUM SPEAKERS

Morning:

Linda Grimsley--author of Guerrilla in the Kitchen
and instructor in Assertiveness Training

Luncheon:

Judy Maddox--National Vice-President of SWE,
Area Supervisor for Computer Programming,
DuPont Company

Careers and Children:

Gene Livingston--Human Factors Engineer, IBM
Margaret K. Hunter--Consulting Architectural Engineer

Career Planning:

George Bland--Manager, IBM

Getting into Management:

Elyse Phillips--Programming Manager, IBM

Getting the Job You Want:

Linda Saunders--College Relations, DuPont
Despina Boinodiris--Engineer, IBM

Money Matters:

Deborah Dudek--Manager of Commercial Credit,
First Citizens Bank and Trust Company

Problems in the School Setting:

Laura Foxx--Counselor, NCSU Counseling Center
Student Representatives from NCSU

Problems in the Work Environment--

Jan Talbot--Chemical Engineer, Oak Ridge National
Laboratory
Caeli Collins-- Engineer, DuPont

Professional Licensing:

Janet O'Brien--Instructor of Mechanical Drafting
and Design, Guilford Technical Institute
Kenneth O. Beatty--Reynolds Professor of Chemical
Engineering, NCSU

THE NCSU SECTION OF THE SOCIETY OF WOMEN
ENGINEERS WISHES TO THANK THE FOLLOWING
COMPANIES WHOSE GENEROUS GIFTS HELPED
MAKE THIS SYMPOSIUM POSSIBLE:

BURROUGHS-WELLCOME
DUKE POWER
E. I. DU PONT
INTERNATIONAL BUSINESS MACHINES
MONSANTO
TROXLER ELECTRONICS

SYMPOSIUM COMMITTEE

COORDINATOR: MARY WHITTON
PUBLICITY: CLAIRE COWART
ARRANGEMENTS: CAROL DRIGGERS
PROGRAM: PATRICIA BECKMAN
ELIN SCHNABEL
ADVISORS: DESPINA BOINODIRIS
FRANCES RICHARDSON

NCSU STUDENT SECTION SOCIETY OF WOMEN ENGINEERS

ANNOUNCING

SPRING SYMPOSIUM FOR WOMEN IN ENGINEERING AND RELATED FIELDS

"ASSERTIVENESS, LIFE-PLANNING, AND DECISION MAKING"

Objectives: To develop techniques of being assertive when dealing with others.
To recognize the difference between being assertive and being aggressive.
To consider the problems women have with life and career planning.
To understand the methods of making decisions and the motives behind those decisions.
To provide an opportunity for students to meet with other women engineering and sciences students.

Location: Jane S. McKimmon Extension Education Center, North Carolina State University, Raleigh, N. C.

Date: Saturday, April 2, 1977

Cost: \$5 preregistration (includes luncheon)

Program Keynote Speaker (National Society of Women Engineers Officer)
Highlights: Assertiveness, Life-Planning, and Decision Making Seminar led by Linda Grimsley, author and experienced group leader
Rap Sessions on topics of concern to participants including:
Careers and Children
Problems in the school setting--academic and social
Do you need to be a Professional Engineer?
Getting into Management
Getting the job you want
Insurance, Credit, and Taxes

Participants: Students in Engineering and related fields from:
North Carolina State University
Duke University
North Carolina A & T University

For more information, contact: Mary C. Whitton, Symposium Coordinator
c/o NCSU Student Section
Society of Women Engineers
2158 Burlington Engineering Laboratories
North Carolina State University
Raleigh, NC 27607

Phone: Evenings--919/833-5401
Days--919/737-3272 (Prof. F. M. Richardson)

PARTICIPANTS IN THE SYMPOSIUM "ASSERTIVENESS, LIFE-PLANNING, & DECISION MAKING"

Linda Atkins
c/o Adult Education Dept.
Poe Hall
NCSU
Raleigh, N.C. 27607

Patricia Beckman
2413C Fairway Dr.
Raleigh, N.C.
Ho
Hope Bryan
16-E Booker Creek Apt.
Chapel Hill, NC 27514

Susan B. Leonard
Box 22015 203-E Carroll
NCSU
Raleigh, NC 27607
(I know she has moved to an apt.)

Sandra G. Collie
2448-H S. Holden Road
Greensboro, NC 27407

Claire Cowart
Box 3390 NCSU
Raleigh 27607
summer: El Taco Estates
3641 Hwy 19 South
Lot #11
Perry, Fla. 32347

Mita Desai
2705 Vanderbilt Ave.
Raleigh, N.C. 27607
(not there this summer)

Carol Driggers
~~1/0/Pr0000t/dnd/GAVI~~ 2304 W. Gordon Ave., Apt. 218
Albany, Ga. 31707 High Point, N.C. 27260

Elaine Feaganes
1825F Fairfan Rd.
Greensboro, NC

Caroline Goby Goodwin
Box 3436 Berry Hall
NCSU
Raleigh, NC 27607

Barbara Hill
507 Fielding Rd.
Charlotte, NC 28214

Chie Ishizaki
209 Landsbury Dr.
Durham, N.C. 27707

Dixie L McCollum
3207 Merriman Ave. Raleigh, N.C. 27607

Marie Moody
2312 Spruce St.
Greensboro, N.C.

Conniesue B. Oldham
4008 Twickenham Ct.
Raleigh, NC

Lisa O'Neal
32 Launcelot Lane
Backing Ridge, NJ

Neena L. Nowell
1803-D S. Dixie St Trail
Raleigh, NC 27606

Jean Anne Ramsey
209 Anderson St. Apt. F
Raleigh, NC

Elizabeth Reynolds
G-22 E. S. King Village
Raleigh, NC 27607

Carolyn Rippy
3022-48A Chapel Hill Rd,
Durham, N.C.

Elin Schnabel
c/O Buckeye Cellulose
Perry, Fla.

Ellen Shapiro
400-A Chamberlain St.
Raleigh, NC

Sue Simone
1211 Tanglewood Ave.
High Point, N.C. 27260

Sharon Stover
509 Montlieu Ave.
High Point, N.C. 27262

Jane Suggs
225 Woodburn Rd.
Raleigh, NC

Elanor Walther
4801-B Bluebird Ct.
Raleigh, N.C.

Mary Wharton
1200 Carlton Ave.
Raleigh, NC 27606

Loretta Williams
311 S. Lasalle St. Apt. 50-T
Durham, NC

Janie Wood
119 Crest St.
Mount Holly, NC 28120

Ann Zdunczyk
Rt. 9, Box 415
Greensboro, NC

Adria Zimmerman
2704 Holly Dr.
Greensboro, NC 27408

NCSU STUDENT SECTION OF THE SOCIETY OF WOMEN ENGINEERS PRESENTS

ASSERTIVENESS
 LIFE-PLANNING
 DECISION MAKING

A SYMPOSIUM FOR WOMEN IN ENGINEERING AND SCIENCES

SATURDAY, APRIL 2, 1977

McKIMMON CENTER, N.C. STATE

PROGRAM

8:30-9:30	Registration and Coffee
Morning Session 9:30-11:45	"Assertiveness Training"--led by Linda Grimsley, author of <u>Guerrilla in the Kitchen</u>
Luncheon Noon	Recognition of Guests and Sponsors Speaker: Ms. Judy Maddox, National Vice President, Society of Women Engineers
Afternoon Session 1:30-5:30	Small Group Workshops--Four Sessions
	<u>Problems in the School Setting</u> --led by students and a representative from the counseling center
	<u>Career Planning</u> --George Bland, IBM
	<u>Professional Licensing</u> --Dr. Kenneth O. Beatty, Reynolds Professor of Chemical Engineering, NCSU
	<u>Getting the Job you Want</u> --Linda Saunders, Recruiter, E. I. DuPont, and Despina Boinodiris, Engineer, IBM
	<u>Problems in the Work Setting</u> --Kathleen Harer, Regional Coordinator, SWE and Judy Maddox, V.P. SWE
	<u>Money Matters</u> --Representative of First-Citizens Bank and Trust Company
	<u>Careers and Children</u> --Dr. Gene Livingstone, Human Factors Engineer, IBM, and Mrs. M.K. Hunter, Architectural Engineer
	<u>Getting into Management</u> --Carol Dumas, Asst. Vice President, Durham Life, and Elyse Phillips, Programming Manager, IBM

REGISTRATION

The registration fee for the symposium is \$5.00 which includes the cost of the luncheon. Make checks payable to the NCSU Society of Women Engineers (no cash please). Either hand deliver your check and the registration blank below to Prof. F.M. Richardson, 140 Riddick or mail to Society of Women Engineers, 2158 Burlington Engineering Laboratories, N.C.S.U. Raleigh, N.C. 27607.

Name _____ Curriculum _____

Address _____ Class _____

Phone _____ Circle One : NCSU DUKE A&T

Phon
834-2644

A **S**YMPOSIUM FOR **W**OMEN IN **E**NGINEERING AND **S**CIENCES

ASSERTIVENESS

LIFE-PLANNING

DECISION MAKING

SATURDAY APRIL 2

SOCIETY OF WOMEN ENGINEERS

**MORE INFO ON S.W.E. BULLETIN BOARD
OPPOSITE 133 RIDDICK**

Leftover Symposium
stuff on front table -

I need registration forms if
we still have them to send
list of attendees to Linda Sanden.

I'll come by Mon. AM if you'll
put them in my box -

Thanks -
Mary